

QUALITY
TRADITION

BENDING

There With YouSM
faster • safer • easier

“There really is no competition. Others spin off and try, but they just can't compete.”

TIM SCULLIN
Director of Warehouse/Purchasing



Greenlee benders are the standard in the industry—it's just a matter of which bender you need.

- 853, four-in-one shoe to bend 1"-2" EMT, IMC and Rigid conduit, no additional shoes required at the job site
- The 855 Smart Bender™ Deluxe Pendant provides hassle-free bending by doing the calculations for you
- Lifting eyes, heavy-duty casters, rugged handles and a finely balanced design are standard safety features

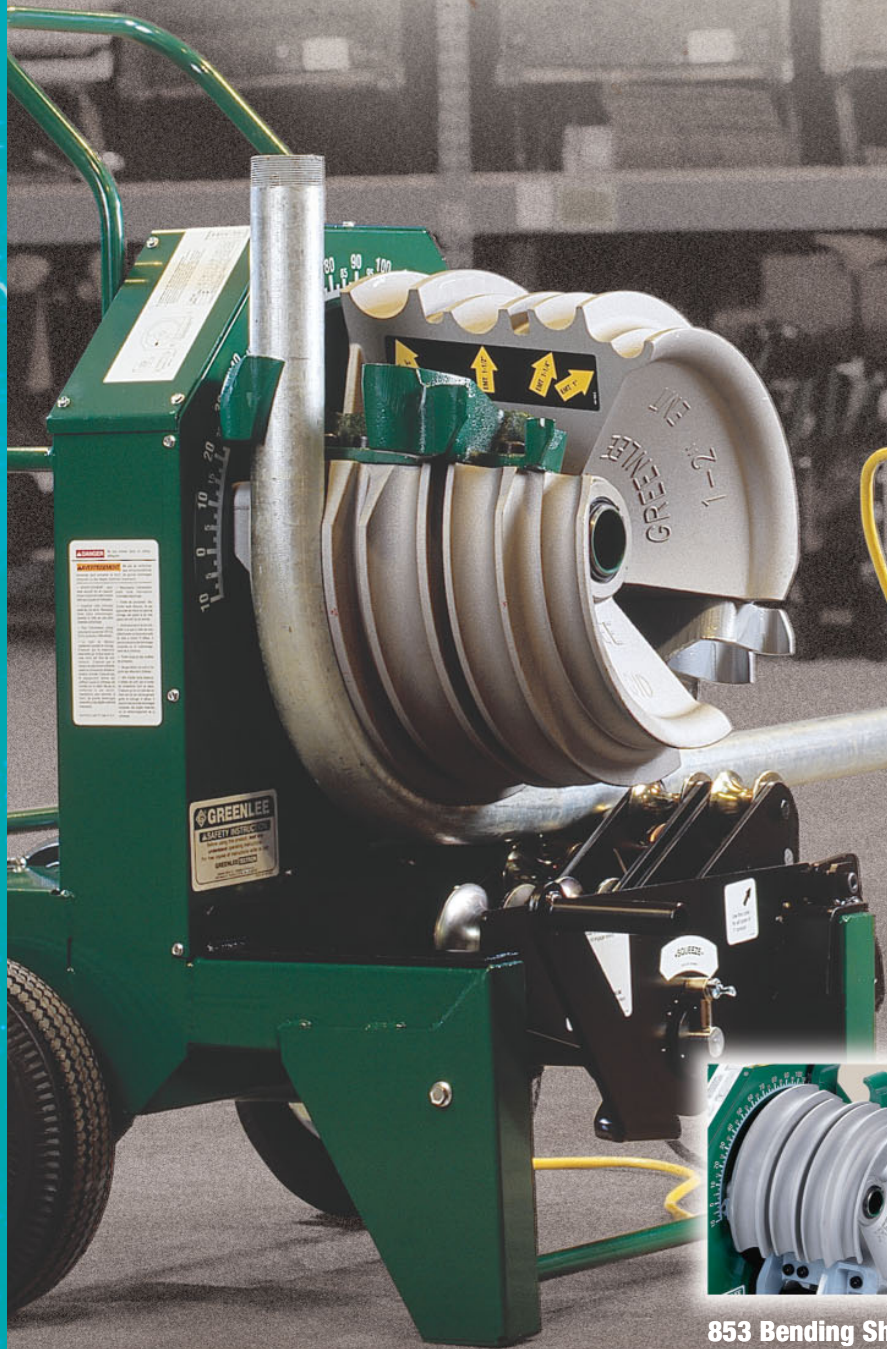

853 Bending Shoe



855 Smart Bender™ Deluxe Pendant



Bending Selection Guide

Combination Bending Rigid EMT IMC Conduit

Table with columns: CAT. NO. - DESCRIPTION, PAGE NO., 1/2", 3/4", 1", 1-1/4", 1-1/2", 2", 2-1/2", 3", 3-1/2", 4", 5". Rows include 1818 Mechanical Bender (EMT), 1818 Mechanical Bender (IMC), 1818 Mechanical Bender (Rigid), 855 Smart Quad Bender, 854 Quad Bender, 555 Electric Bender Rigid & EMT, 555 Electric Bender IMC, 853 Quad Bender, 882 & 882CB Hydraulic Bender, 881 & 881CT Hydraulic Bender.

*Correct shoe group required

Rigid Conduit Bending

Table with columns: CAT. NO. - DESCRIPTION, PAGE NO., 1/2", 3/4", 1", 1-1/4", 1-1/2", 2", 2-1/2", 3", 3-1/2", 4", 5". Rows include Hand Benders - SITE-RITE Aluminum, Hand Benders - SITE-RITE II Malleable Iron, Hand Benders - Hickeys, 1800 Mechanical Bender, 1801 Mechanical Bender, 1818 & 1818R Mechanical Bender, 855 Smart Quad Bender, 854 Quad Bender, 853 Quad Bender, 555R Electric Bender, 882CB Hydraulic Bender, 881 & 881CT Hydraulic Bender, 880 Hydraulic Bender, 777 Hydraulic Bender, 884 Hydraulic Bender, 885 Hydraulic Bender.

EMT Conduit Bending

Table with columns: CAT. NO. - DESCRIPTION, PAGE NO., 1/2", 3/4", 1", 1-1/4", 1-1/2", 2", 2-1/2", 3", 3-1/2", 4", 5". Rows include Hand Benders - SITE-RITE Aluminum, Hand Benders - SITE-RITE II Malleable Iron, 1818 & 1818T Mechanical Bender, 855 Smart Quad Bender, 854 Quad Bender, 853 Quad Bender, 555E Electric Bender, 882 & 882CB Hydraulic Bender, 881 & 881CT Hydraulic Bender.

IMC Conduit Bending

Table with columns: CAT. NO. - DESCRIPTION, PAGE NO., 1/2", 3/4", 1", 1-1/4", 1-1/2", 2", 2-1/2", 3", 3-1/2", 4", 5". Rows include Hand Benders - SITE-RITE Aluminum, Hand Benders - SITE-RITE II Malleable Iron, 1800 Mechanical Bender, 1801 Mechanical Bender, 1818 & 1818R Mechanical Bender, 855 Smart Quad Bender, 854 Quad Bender, 853 Quad Bender, 555I Electric Bender, 882CB Hydraulic Bender, 881 & 881CT Hydraulic Bender.

PVC Coated Rigid Conduit Bending

Table with columns: CAT. NO. - DESCRIPTION, PAGE NO., 1/2", 3/4", 1", 1-1/4", 1-1/2", 2", 2-1/2", 3", 3-1/2", 4", 5". Rows include 855 Smart Quad Bender with 01700 PVC Shoe Group, 854 Quad Bender with 01700 PVC Shoe Group, 853 Quad Bender with 01700 PVC Shoe Group, 555 Electric Bender with 37279 Shoe Group, 880 PVC Hydraulic Bender, 884 PVC Hydraulic Bender.

✓ = One Shot Capability. S = Segment Bend Only. See pages 85 and 86 for PVC Blankets and Heaters for bending PVC.

SITE-RITE® Heat-Treated Aluminum and SITE-RITE II® Malleable Iron Hand Benders

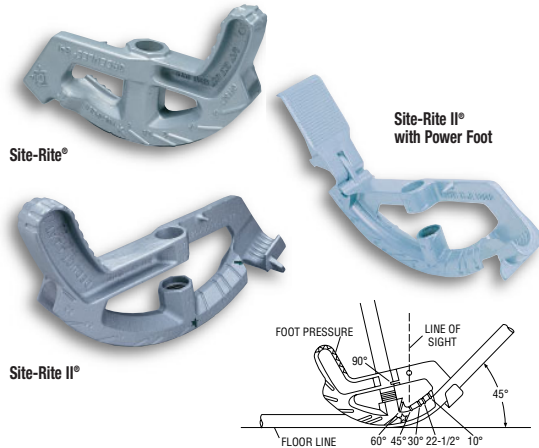

Both Benders feature:

- Handle straight up and down for 30° bends.
- Patented sight indicator on bender is a key feature for bending angles fast and easy.
- Non-slip, contoured pedal for added leverage.
- Strong, stable square hook design.
- Cast-in markings for stub-ups, saddle bends, back-to-back bends, and head-up or down bending.

SITE-RITE® Aluminum Benders feature:

- Special design and heat-treated aluminum construction make this patented hand bender significantly stronger.
- Cast-in offset multipliers.

8843 SITE-RITE II® Malleable Iron Bender features:

- Ratcheting Power Foot to provide more leverage, reduce bending effort.

SPECIFICATIONS

Capacity	1/2" - 1-1/4" EMT, 1/2" - 1" Rigid	
Weight	840 – 1.4 lbs. (.7 kg)	8840 – 3.1 lbs. (1.4 kg)
	840H – 5.5 lbs. (2.5 kg)	8841 – 4.3 lbs. (2.0 kg)
	841 – 2.1 lbs. (0.9 kg)	8842 – 7.2 lbs. (3.3 kg)
	841H – 6.4 lbs. (2.9 kg)	8843 – 16.2 lbs. (7.3 kg)
	842 – 3.5 lbs. (1.6 kg)	8840H – 7 lbs. (3.2 kg)
	842H – 11 lbs. (5 kg)	8841H – 9 lbs. (4.1 kg)
	843 – 8.3 lbs. (3.8 kg)	8842H – 15 lbs. (6.8 kg)

CENTERLINE BENDING RADII

EMT	RIGID IMC	CENTERLINE RADII	HEAT-TREATED ALUMINUM	MALLEABLE IRON
1/2"		4-3/16" (106.5 mm)	840, 840H	8840, 8840H
3/4"	1/2"	5-1/8" (130.2 mm)	841, 841H	8841, 8841H
1"	3/4"	6-1/2" (165.1 mm)	842, 842H	8842, 8842H
1-1/4"	1"	11" (279.4 mm)	843	—
1-1/4"	1"	9-5/8" (244.5 mm)	—	8843

CAT. NO.	UPC NO.	DESCRIPTION
840	23533	SITE-RITE® Hand Bender for 1/2" EMT
841	23392	SITE-RITE® Hand Bender for 3/4" EMT, 1/2" Rigid, IMC
842	23564	SITE-RITE® Hand Bender for 1" EMT, 3/4" Rigid, IMC
843	23667	SITE-RITE® Hand Bender for 1-1/4" EMT, 1" Rigid, IMC
840H	32917	SITE-RITE® Hand Bender with handle for 1/2" EMT
841H	32918	SITE-RITE® Hand Bender with handle for 3/4" EMT, 1/2" Rigid
842H	32919	SITE-RITE® Hand Bender with handle for 1" EMT, 3/4" Rigid
8840	35094	SITE-RITE II® Hand Bender for 1/2" EMT
8841	35095	SITE-RITE II® Hand Bender for 3/4" EMT, 1/2" Rigid, IMC
8842	35096	SITE-RITE II® Hand Bender for 1" EMT, 3/4" Rigid, IMC
8843	35097	SITE-RITE II® Power Foot Bender for 1-1/4" EMT, 1" Rigid, IMC
8840H	35482	SITE-RITE II® Hand Bender with handle for 1/2" EMT
8841H	35483	SITE-RITE II® Hand Bender with handle for 3/4" EMT, 1/2" Rigid
8842H	35484	SITE-RITE II® Hand Bender with handle for 1" EMT, 3/4" Rigid
845	25567	Handle for 1/2" and 3/4" Hand Benders
846	25568	Handle for 1" Hand Benders
846-1-1/4	06490	Handle for 1-1/4" Benders

HICKEYS with Welded Handles



- Heavy-duty cast steel head.
- Welded steel handle.
- Bend tight radius stub-ups.

CAT. NO.	UPC NO.	DESCRIPTION
508	18102	Hickey for 1/2" Rigid
512	18103	Hickey for 3/4" Rigid
516	18104	Hickey for 1" Rigid

SPECIFICATIONS

Capacity	1/2" - 1" Rigid	
Weight	508 – 6.9 lbs. (3.1 kg)	512 – 8 lbs. (3.6 kg) 516 – 13 lbs. (5.9 kg)

Little Kicker® Offset Bender



- Bends offsets in one easy operation. Insert conduit, depress handle, release and remove conduit.
- Makes identical offsets every time for wall mounted boxes with exposed conduit.
- Depress handle to create offset that matches the knockout in box.
- Maximum offset of .56" (9/16).

CAT. NO.	UPC NO.	DESCRIPTION
1810	13815	Offset Bender for 1/2" EMT
1811	14159	Offset Bender for 3/4" EMT

SPECIFICATIONS

Capacity	1810 – 1/2" EMT
	1811 – 3/4" EMT
Weight	1810 – 8.75 lbs. (4 kg)
	1811 – 8.50 lbs. (3.9 kg)

Mechanical Benders for IMC and Rigid Conduit



- Ratchet action for increased leverage.
- Bypass the ratchet for fast, direct bending on smaller sizes.
- Heavy-duty welded construction for long, reliable service.
- Built-in bending degree indicator and easy to use bending charts for accurate, consistent bends.

CAT. NO.	UPC NO.	DESCRIPTION
1800	24400	Mechanical Bender for 1/2", 3/4", 1" IMC and Rigid conduit
1800G1	24401	Mechanical Bender without undercarriage, for bench or truck bed mounting. Bends 1/2", 3/4", 1" IMC and Rigid conduit
1801	24753	Mechanical Bender for 1-1/4", 1-1/2" IMC and Rigid conduit
1801G1	24507	Mechanical Bender without undercarriage, for bench or truck bed mounting. Bends 1-1/4", 1-1/2" IMC and Rigid conduit
32416	32416	Undercarriage Unit for 1800 and 1801

Use a 5' (1.5 m) length of 1" Rigid conduit for the handle.

SPECIFICATIONS

Capacity	1800, 1800G1 – 1/2", 3/4" and 1" IMC and Rigid
	1801, 1801G1 – 1-1/4" and 1-1/2" IMC and Rigid
Weight	1800 – 81 lbs. (36.7 kg)
	1801 – 104 lbs. (47.2 kg)
	1800G1 – 48 lbs. (21.8 kg)
	1801G1 – 75 lbs. (34 kg)

CENTERLINE BENDING RADII

1800, 1800G1	1/2" Rigid conduit	2-5/8"	(66.7 mm)
	3/4" Rigid conduit	4-5/8"	(117.5 mm)
	1" Rigid conduit	5-7/8"	(149.2 mm)
1801, 1801G1	1-1/4" Rigid conduit	8-1/16"	(204.8 mm)
	1-1/2" Rigid conduit	9-11/16"	(246.1 mm)

Mechanical Benders for EMT, IMC, Rigid and Aluminum Conduit

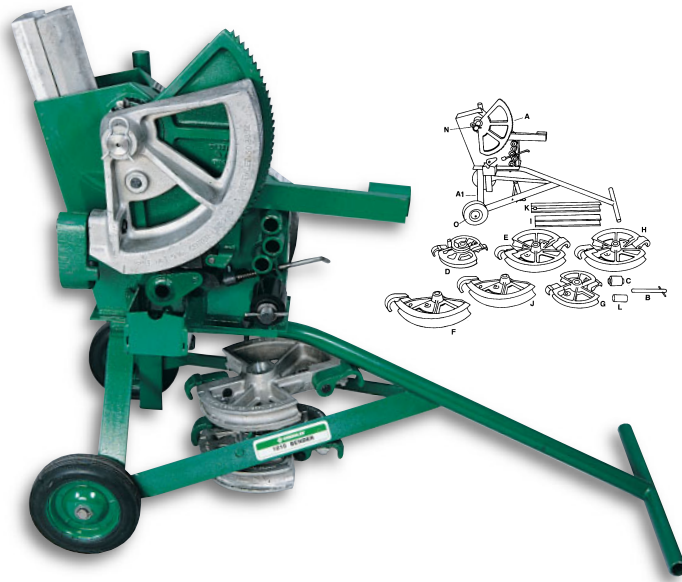

- Bends a wide variety of types and sizes of conduit.
- Durable ratchet mechanism for easy bending.
- Bypass the ratchet for fast, direct bending on smaller sizes.
- Bending degree indicator and charts for fast, easy, accurate bending.
- All shoe and bending accessories can be mounted to the frame unit and secured with a chain and lock.
- Heavy-duty undercarriage with wheels.

CAT. NO.	UPC NO.	DESCRIPTION
1818	22192	Mechanical Bender for 3/4" through 2" EMT conduit, 1/2" through 1-1/4" IMC conduit and 1/2" through 1-1/2" Rigid and aluminum conduit
1818R	20231	Mechanical Bender for 1/2" through 1-1/4" IMC conduit and 1/2" through 1-1/2" Rigid and aluminum conduit
1818T	20232	Mechanical Bender for 3/4" through 2" EMT conduit
1818G1	22220	Frame and undercarriage unit only

KEY	CAT. NO.	UPC NO.	DESCRIPTION	BENDERS				SHOE GROUPS*		
				1818	1818R	1818T	1818G1	36905	36906	36907
A	36085	36085	Bender Head Unit	1	1	1	1			
A1	36247	36247	Undercarriage Unit	1	1	1	1			
B	36697	36697	Roller Pin Unit	1	1	1		1	1	1
C	18681	18681	Cushioned Roller Unit	1	1	1		1	1	1
D	18827	18827	1/2, 3/4 & 1" Rigid/IMC Shoe Unit	1	1			1	1	
E	18828	18828	1-1/4" Rigid/IMC; 1-1/2" Rigid Shoe Unit	1	1			1	1	
G	18830	18830	3/4 & 1" EMT Shoe Unit	1		1		1		1
H	18831	18831	1-1/4 & 1-1/2" EMT Shoe Unit	1		1		1		1
I	18642	18642	1-1/4 & 1-1/2" EMT Follow Bar	1		1		1		1
J	18832	18832	2" EMT Shoe Unit	1		1		1		1
K	18636	18636	2" EMT Follow Bar	1		1		1		1
L	36296	36296	Roller Follow Bar Guide	1		1		1		1
N	18772	18772	Retainer Clip	1	1	1		1	1	1
O	51509	51509	Wheel	2	2	2				
F	18829	18829	2" Rigid Aluminum Shoe Unit	OPTIONAL						
	23818	23818	Steel Storage Box For Shoe Units							

* SHOE GROUPS Reference chart for ordering bending accessories.

SPECIFICATIONS

Capacity

EMT – 3/4" - 2"

RIGID: 1/2" - 1-1/2"

IMC – 1/2" - 1-1/4"

ALUMINUM: 1/2" - 1-1/2"

Weight

1818 – 250 lbs. (114 kg)

1818T – 217 lbs. (99 kg) 1818R – 185 lbs. (84 kg)

Use a 5' (1.5m) length of 1-1/4" Rigid conduit for the handle

CENTERLINE BENDING RADII

SHOE SIZE	INCHES	mm
1/2" Rigid/IMC	2-21/32"	67.5
3/4" Rigid/IMC	4-5/8"	117.5
3/4" EMT	5-3/32"	129.4
1" Rigid/IMC	5-7/8"	149.2
1" EMT	6-13/32"	162.7
1-1/4" Rigid/IMC	7-3/8"	187.3
1-1/4" EMT	8-9/32"	210.3
1-1/2" Rigid	9"	228.6
1-1/2" EMT	8-9/32"	210.3
2" EMT	9-3/16"	233.4
2" Aluminum	10-15/32"	265.9

Smart Quad Bender™ Electric Conduit Bender for 1/2" to 2" EMT, IMC, Rigid and Rigid Aluminum



- Bends a variety of types and sizes of conduit.
- Intelligent pendant controls: Standard (included), digital readout and programmable bend angles for accurate repeat bends. Deluxe (optional), interactive control – calculates complete layout measurements for various types of bends.
- Bends 1/2" to 2" EMT, IMC, Rigid and Rigid aluminum conduit without any shoe changes. No loose parts to get lost.
- Two operating positions; table top and upright.
- Optional shoes available to bend PVC coated steel conduit.
- Adjustable leveler pads.
- Excellent portability. Convenient lifting eyes.
- Weather-resistant construction.
- Squeeze adjustment to compensate for variations in EMT conduit.

CAT. NO.	UPC NO.	DESCRIPTION
855	08550	Smart Bender™ for 1/2" - 2" EMT, IMC and Rigid conduit (Includes Standard Pendant)
38650	38650	Deluxe Pendant for older bender with serial code ZW
01711	01711	Deluxe Pendant for current bender with serial code ABL
38863	38863	Standard Pendant for older bender with serial code ZW
01648	01648	Standard Pendant for current bender with serial code ABL
38780	38780	Shoe Unit, 1/2" - 1-1/4"
38148	38148	Shoe Unit, 1-1/2" - 2"
01700	01700	PVC Shoe Unit, 1/2" - 2" for bender with serial code ABL only
38962	38962	Vinyl Rain Cover

SPECIFICATIONS

Capacity	1/2" - 2" EMT, IMC, Rigid and Rigid Aluminum conduit
Power Source	120 VAC; 20 Amp
Weight	510 lbs. (231.3 kg)

See Centerline Bending Radii Information Below

Quad Bender™ Electric Conduit Bender for 1/2" to 2" EMT, IMC, Rigid and Rigid Aluminum



- Bends 1/2" to 2" EMT, IMC, Rigid and Rigid Aluminum conduit without any shoe changes. No loose parts to get lost.
- Two operating positions; tabletop and upright.
- Remote pendant switch and bending data charts for easy, accurate bends.
- Simple setup and easy operation.
- Squeeze adjustment to compensate for variations in EMT conduit.
- Adjustable leveler pads.
- Excellent portability. Convenient lifting eyes.
- Optional shoes available to bend PVC coated steel conduit.

CAT. NO.	UPC NO.	DESCRIPTION
854	03106	Quad Bender™ for 1/2" - 2" EMT, IMC, Rigid and Rigid Aluminum conduit.
38780	38780	Shoe Unit, 1/2" - 1-1/4"
38148	38148	Shoe Unit, 1-1/2" - 2"
01700	01700	PVC Shoe Unit, 1/2" - 2" (optional)

SPECIFICATIONS

Capacity	1/2" - 2" EMT, IMC, Rigid and Rigid Aluminum conduit
Power Source	120 VAC; 20 Amp
Weight	510 lbs. (231.3 kg)

See Centerline Bending Radii Information Below

CENTERLINE BENDING RADII

SHOE SIZE	INCHES	mm	SHOE SIZE	INCHES	mm	SHOE SIZE	INCHES	mm
1/2" EMT	4-5/16"	109.5	1" EMT	7"	177.8	1-1/2" EMT	8-3/8"	212.7
1/2" IMC/Rigid	4-1/4"	108.0	1" IMC/Rigid	6-15/16"	176.2	1-1/2" IMC/Rigid	8-1/4"	209.6
3/4" EMT	5-1/2"	139.7	1-1/4" EMT	8-13/16"	223.8	2" EMT	9-1/4"	235.0
3/4" IMC/Rigid	5-7/16"	138.1	1-1/4" IMC/Rigid	8-3/4"	222.3	2" IMC/Rigid	9"	228.6



Electric Conduit Bender for 1" to 2" EMT, IMC, Rigid Steel and Aluminum



- Four-in-one-shoe handles 1", 1-1/4", 1-1/2", 2" EMT, IMC and Rigid steel and aluminum conduit.
- Puncture-proof pneumatic tires with steel rims and precision ball bearings for tough jobsite conditions.
- Quickly remove the shoe and bridge to reduce weight for easy handling.
- Easy to load and unload.
- Squeeze adjustment to compensate for conduit variations. Smooth wrinkle-free bends.

CAT. NO.	UPC NO.	DESCRIPTION
853	07272	Quad Bender™ for 1" – 2" EMT, IMC, and Rigid conduit
37279	37279	40 Mil PVC Shoe Group

SPECIFICATIONS

Capacity	1" - 2" EMT, IMC, and Rigid conduit
Power Source	120 VAC; 20 Amp
Weight	445 lbs. (202 kg); 275 lbs. (125 kg) without shoe & bridge
Height	44" (1118 mm)
Width	30.5" (775 mm)
Depth	35" (889 mm)

555® Deluxe Bender Electric Conduit Bender for 1/2" through 2" Conduit and Pipe



Pneumatic Tires



- 555® Deluxe Series features unique electrical controls that reduce the in-rush current to the relays to minimize the contact arcing for longer life, heavy-duty urethane filled puncture-proof pneumatic tires and UL/ULC approved.
- Available in four models for Rigid, EMT or IMC conduit, or bender only without shoes.
- The optional PVC-coated rigid conduit shoe group can be used on all 555® series benders.

CAT. NO.	UPC NO.	DESCRIPTION
555®	39780	Deluxe Electric Bender power unit without bending accessories
555R	23446	Deluxe Electric Bender with Shoe Group for 1/2" through 2" Rigid and 1/2" through 1-1/4" IMC conduit and pipe includes 28007 – 1/2" - 2" Rigid Shoe Group
555E	27989	Deluxe Electric Bender with Shoe Group for 1/2" through 2" EMT conduit includes 23802 – 1/2" - 2" EMT Shoe Group
555I	27990	Deluxe Electric Bender with Shoe Group for 1-1/2" through 2" IMC conduit includes 26330 – 1-1/2" - 2" IMC Shoe Group
555-22	39971	220 VAC 50/60 Cycle Electric Bender power unit without bending accessories
37279	37279	40 Mil PVC Coated Rigid 1/2" - 2" Shoe Group (sold separately) to use with the 555 series benders

SPECIFICATIONS

Capacity	555R: 1/2" - 2" Rigid and 1/2" - 1-1/4" IMC conduit	Weight	555: 260 lbs. (118 kg)
	555E: 1/2" - 2" EMT conduit		555R: 393 lbs. (179 kg)
	555I: 1-1/2" and 2" IMC conduit		555E: 476 lbs. (216 kg)
Power Source	555 Deluxe Series: 120 VAC;		555I: 456 lbs. (207 kg)
	20 Amp GFCI-protected receptacle	Height	555 Deluxe Series: 44" (1118 mm)
Operating Temperature	-5°F to 120°F (-20°C to 49°C)	Width	555 Deluxe Series: 29-5/8" (753 mm)
Relative Humidity	0-98%	Depth	555 Deluxe Series: 28-1/2" (724 mm)

555® Classic Bender Electric Conduit Bender for 1/2" through 2" Conduit and Pipe



- The 555C Classic Series features simple relay controls for easy field repairs, and compact handle design to prevent interference with conduit when bending.
- Available in four models for Rigid, EMT or IMC conduit, or bender only without shoes.
- The optional PVC-coated rigid conduit shoe group can be used on all 555® series benders.

CAT. NO.	UPC NO.	DESCRIPTION
555C	06900	Classic Electric Bender power unit without bending accessories
555RC	06901	Classic Electric Bender with Shoe Group for 1/2" through 2" Rigid and 1/2" through 1-1/4" IMC conduit and pipe includes 28007 – 1/2" - 2" Rigid Shoe Group
555EC	06902	Classic Electric Bender with Shoe Group for 1/2" through 2" EMT conduit includes 23802 – 1/2" - 2" EMT Shoe Group
555IC	06903	Classic Electric Bender with Shoe Group for 1-1/2" through 2" IMC conduit includes 26330 – 1-1/2" - 2" IMC Shoe Group
37279	37279	40 MIL PVC Coated Rigid 1/2" - 2" Shoe Group (sold separately) to use with the 555 series benders

SPECIFICATIONS

Capacity	555R and 555RC: 1/2"-2" Rigid and 1/2" - 1-1/4" IMC conduit
	555E and 555EC: 1/2" - 2" EMT conduit
	555I and 555IC: 1-1/2" and 2" IMC conduit
Power Source	555C Classic Series: 120 VAC; 20 amp GFCI-protected receptacle
Weight	555C: 260 lbs. (118 kg)
Height	555C Classic Series: 44" (1118 mm)
Width	555C Classic Series: 28.5" (724 mm)
Depth	555C Classic Series: 28-1/2" (724 mm)
Operating Temperature	-5°F to 120°F (-20°C to 49°C)
Relative Humidity	0-98%



555® Accessory Shoe Groups

23802 1/2" - 2" EMT SHOE GROUP CONSISTS OF ONE EACH:

KEY	CAT. NO.	UPC NO.	DESCRIPTION
1	17944	17944	1/2" through 1-1/4" EMT Bending Shoe
2	17986	17986	1/2" through 1-1/4" Support Roller
3	23499	23499	1-1/2" EMT Bending Shoe
4	23505	23505	2" EMT Bending Shoe
5	23541	23541	1-1/2" through 2" Roller Support Unit
	23818	23818	Metal Storage Box (not shown)

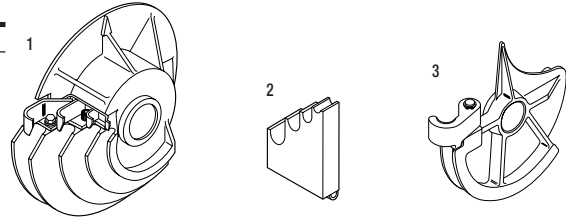

23816 1-1/2" AND 2" EMT SHOE GROUP CONSISTS OF ONE EACH:

KEY	CAT. NO.	UPC NO.	DESCRIPTION
3	23499	23499	1-1/2" EMT Bending Shoe
4	23505	23505	2" EMT Bending Shoe
5	23541	23541	1-1/2" through 2" Roller Support Unit

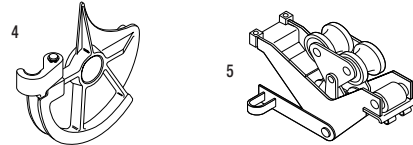

26330 1-1/2" AND 2" IMC SHOE GROUP CONSISTS OF ONE EACH:

KEY	CAT. NO.	UPC NO.	DESCRIPTION
6	25263	25263	1-1/2" IMC Bending Shoe
7	25268	25268	2" IMC Bending Shoe
8	25273	25273	1-1/2" through 2" Roller Support Unit
	23818	23818	Metal Storage Box (not shown)

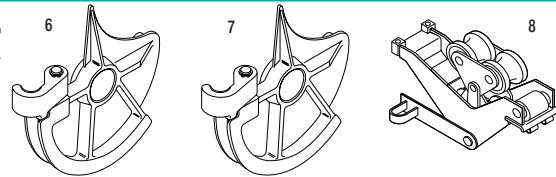

28007 1/2" - 2" RIGID SHOE GROUP CONSISTS OF ONE EACH:

KEY	CAT. NO.	UPC NO.	DESCRIPTION
9	00571	00571	1/2" through 1-1/4" Rigid/IMC Bending Shoe
10	00936	00936	1/2" through 1-1/4" Support Roller
11	17937	17937	1-1/2" through 2" Rigid Bending Shoe
12	17984	17984	1-1/2" through 2" Support Roller

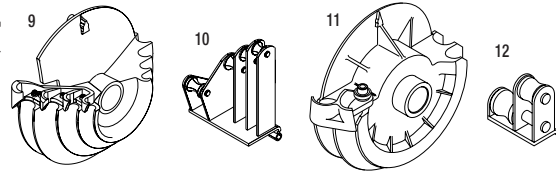

37279 40 MIL PVC COATED RIGID 1/2" - 2" SHOE GROUP CONSISTS OF ONE EACH:

KEY	CAT. NO.	UPC NO.	DESCRIPTION
13	00946	00946	1/2" through 1-1/4" Roller Support
14	00573	00573	1/2" through 1-1/4" Shoe
15	37281	37281	1-1/2" and 2" Shoe
16	37282	37282	1-1/2" through 2" Roller Support
	23818	23818	Metal Storage Box (not shown)

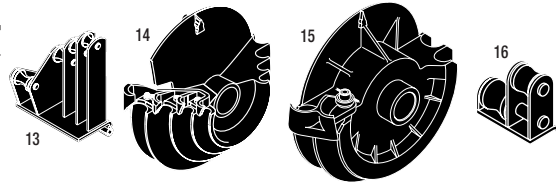

To use the PVC Shoe Group with 555 SB and 555 SBR benders Adapter Set 32391 is required.

Flip-Top® Benders for 1-1/4" - 2" EMT, IMC and Rigid

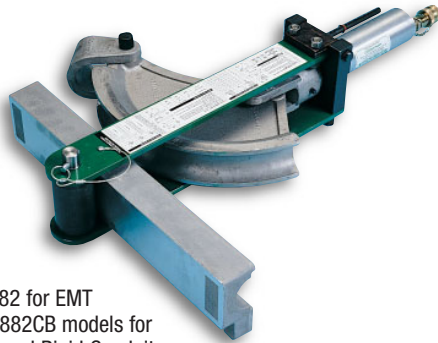

- Choose 882 for EMT bends or 882CB models for EMT, IMC and Rigid Conduit.
- Simple, accurate and easy to use.
- Flip-Top® hinged frame top plate opens for easy, fast loading and unloading.
- Ram travel scale and charts for accurate bends, offsets and saddles.

FLIP-TOP® BENDER CENTERLINE BENDING RADII

SIZE	882, 882CB		882CB	
	EMT	RIGID	EMT	IMC
1-1/4"	7-7/32" (183.4 mm)	7-1/4" (184.2 mm)	7-1/4" (184.2 mm)	
1-1/2"	8-1/16" (204.8 mm)	8-1/4" (209.5 mm)	8-1/4" (209.5 mm)	
2"	9-5/16" (236.5 mm)	8-7/8" (225.4 mm)	8-7/8" (225.4 mm)	

CAT. NO.	UPC NO.	DESCRIPTION
882	15128	Flip-Top® Bender for 1-1/4", 1-1/2" and 2" EMT Conduit without Hydraulic Pump
882CB	29536	Flip-Top® Bender with shoes for 1-1/4", 1-1/2" and 2" EMT, IMC and Rigid Conduit without Hydraulic Pump
882CB-H755	29537	Flip-Top® Bender with shoes for 1-1/4", 1-1/2" and 2" EMT, IMC and Rigid Conduit with 755 Hand Hydraulic Pump
882CB-E975	34202	Flip-Top® Bender with shoes for 1-1/4", 1-1/2" and 2" EMT, IMC and Rigid Conduit with 975 Electric Hydraulic Pump
882-H755	16460	Flip-Top® Bender for 1-1/4", 1-1/2" and 2" EMT Conduit with 755 Hand Hydraulic Pump
882-E975	34201	Flip-Top® Bender for 1-1/4", 1-1/2" and 2" EMT Conduit with 975 Electric Hydraulic Pump
882RI-G1	29948	Conversion Attachment Set - Converts 882 to 882CB by adding the shoes, follow bars and saddles for 1-1/4", 1-1/2" and 2" IMC and Rigid conduit

SPECIFICATIONS

Capacity	Weight
882 - 1-1/4", 1-1/2" and 2" EMT	882 - 141 lbs. (64kg)
882CB - 1-1/4", 1-1/2" and 2" EMT, IMC and Rigid	882-H755 - 161 lbs. (73 kg)
Power Source	882CB-H755 - 217 lbs. (99 kg)
755 - Hydraulic Hand Pump	882CB-E975 - 264 lbs. (120 kg)
975 - 120 VAC Electric Hydraulic Pump	882-E975 - 195 lbs. (89 kg)
976-22PS - 220 VAC 50/60 Cycle Electric Hydraulic Pump	882CB - 205 lbs. (93 kg)

Flip Top® Benders and Shoe Groups

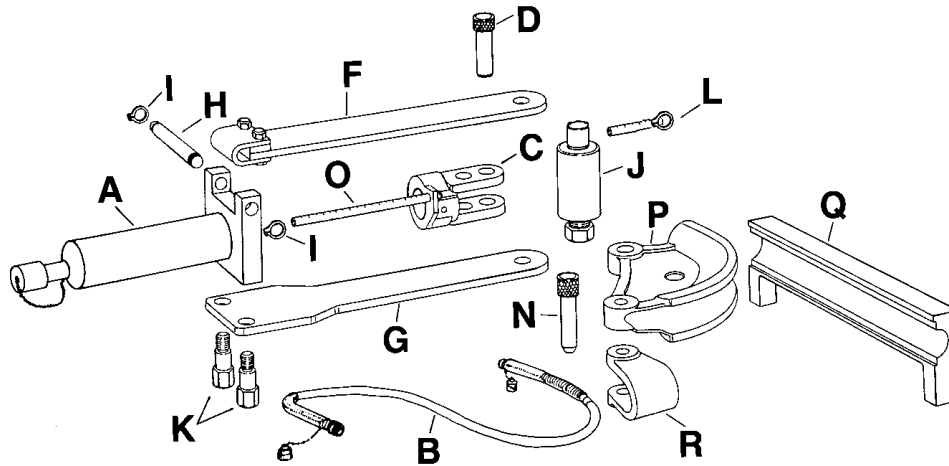

KEY	CAT NO.	UPC NO.	DESCRIPTION	BENDERS				SHOE GROUPS				
				882	882CB	882RI-G1	RI-G20	RI-G24	RI-G32	T-G7	T-G8	T-G9
A	1738	15129	Hydraulic Ram with 4018GB female quick Coupler	1	1							
B	11289	11289	3/8" x 6' (9.5 x 1829 mm) Hydraulic Hose with two 4033GB male quick couplers	1	1							
C	15145	15145	Yoke	1	1							
D	04086	04086	Yoke Pin	1	1							
E	16563	16563	Frame Unit (includes Keys F thru K)	1	1							
F	15136	15136	Upper Connecting Plate Unit	1	1							
G	15135	15135	Lower Connecting Plate Unit	1	1							
H	15150	15150	Hinge Pin	1	1							
I	50283	50283	Retaining Ring	2	2							
J	38778	38778	Roller Unit with pin (L)	1	1							
K	15147	15147	Anchor Stud	2	2							
L	54303	54303	Hitch Pin, 3/8 x 1-1/2	1	1							
N	29937	29937	Saddle Pin	1	1	1						
O	50848	50848	Scale Jam Nut									
O	52867	52867	Scale O-Ring									
O	21954	21954	Scale Piston	1	1							
	23274	23274	Steel Storage Box (not shown)	1	1							
P	11146	11146	1-1/4" EMT Shoe	1	1					1		
Q	11126	11126	1-1/4" EMT Follow Bar	1	1					1		
R	11075	11075	1-1/4" EMT Saddle	1	1					1		
P	14287	14287	1-1/2" EMT Shoe	1	1						1	
Q	11107	11107	1-1/2" EMT Follow Bar	1	1						1	
R	11072	11072	1-1/2" EMT Saddle	1	1						1	
P	11132	11132	2" EMT Shoe	1	1							1
Q	11089	11089	2" EMT Follow Bar	1	1							1
R	14279	14279	2" EMT Saddle	1	1							1
P	29474	29474	1-1/4" IMC and Rigid Shoe		1	1	1					
Q	29477	29477	1-1/4" IMC and Rigid Follow Bar		1	1	1					
R	29465	29465	1-1/4" IMC and Rigid Saddle		1	1	1					
P	29470	29470	1-1/2" IMC and Rigid Shoe		1	1		1				
Q	29472	29472	1-1/2" IMC and Rigid Follow Bar		1	1		1				
R	29464	29464	1-1/2" IMC and Rigid Saddle		1	1		1				
P	29466	29466	2" IMC and Rigid Shoe		1	1			1			
Q	29468	29468	2" IMC and Rigid Follow Bar		1	1			1			
R	29463	29463	2" IMC and Rigid Saddle		1	1			1			



Cam Track® Conduit Benders for 2-1/2" to 4" EMT, IMC and Rigid

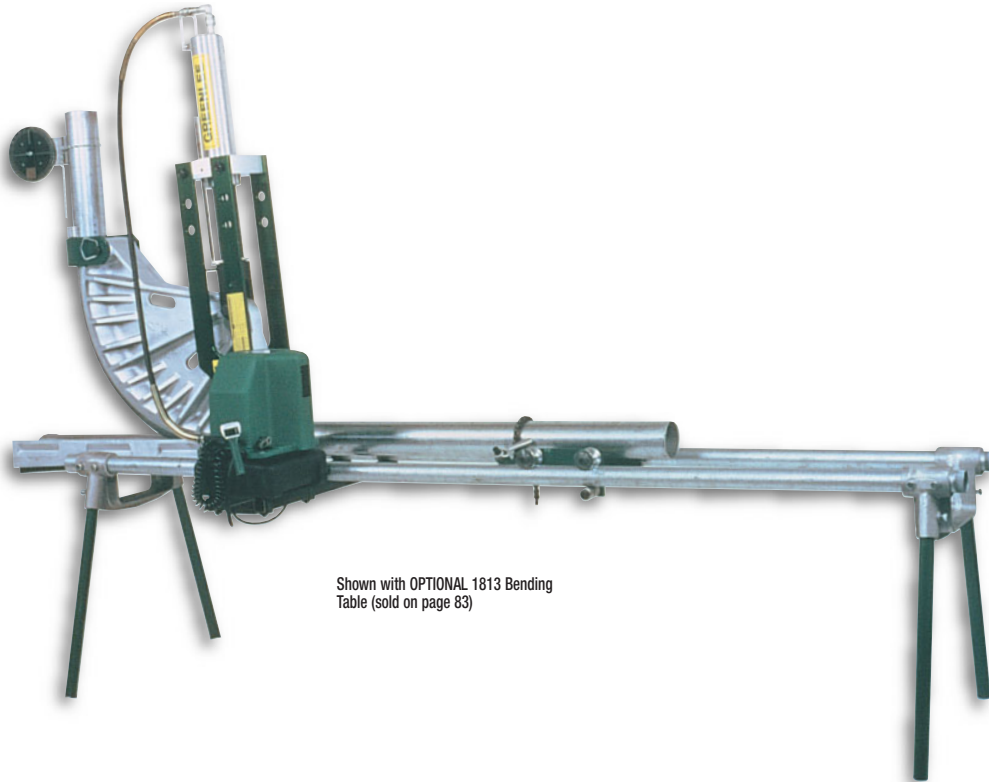

Shown with OPTIONAL 1813 Bending Table (sold on page 83)

CAT. NO.	UPC NO.	DESCRIPTION
881CT	31287	Cam Track® Conduit Bender for One Shot 90° Bends in 2-1/2", 3", 3-1/2" and 4" EMT, IMC and Rigid conduit, without hydraulic pump
881CT-E980	34208	Cam Track® Conduit Bender for One Shot 90° Bends in 2-1/2", 3", 3-1/2" and 4" EMT, IMC and Rigid conduit, with 980 Electric Hydraulic Pump
881CTD	38466	Cam Track® Conduit Bender for One Shot 90° Bends in 2-1/2", 3" and 4" EMT, IMC and Rigid conduit, without hydraulic pump
881CTD-E980	38467	Cam Track® Conduit Bender for One Shot 90° Bends in 2-1/2", 3" and 4" EMT, IMC and Rigid conduit, with 980 Electric Hydraulic Pump
881	27778	Conduit Bender for One Shot 90° Bends in 2-1/2" and 3", Two Shot 90° Bends in 3-1/2" and 4" EMT, IMC and Rigid conduit, without hydraulic pump
881-E980	34205	Hydraulic Conduit Bender for One Shot 90° Bends in 2-1/2" and 3", Two Shot 90° Bends in 3-1/2" and 4" EMT, IMC and Rigid conduit, with 980 Electric Hydraulic Pump
881 BASIC	35711	Conduit Bender without shoe groups or hydraulic pump
27554	27554	2-1/2" – One Shot 90° EMT, IMC, Rigid Shoe Group
27555	27555	3" – One Shot 90° EMT, IMC, Rigid Shoe Group
31281	31281	3-1/2" – One Shot 90° EMT, IMC, Rigid Shoe Group
27556	27556	3-1/2" – 45° EMT, IMC, Rigid Shoe Group (requires 2 bends to make a 90°)
31274	31274	4" – One Shot 90° EMT, IMC, Rigid Shoe Group
27557	27557	4" – 45° EMT, IMC, Rigid Shoe Group (requires 2 bends to make a 90°)
1813	28901	Bending Table for 881 Series Bender (see page 81)
881A	27553	Converts 884 or 885 to an 881

- One bender to bend EMT, IMC and Rigid Conduit.
- Fast and easy set-up on the jobsite.
- True one shot 90° bends with CT models for quick accurate bends.
- Steel reinforced follow bars for long life.
- Bend a 90° elbow in 4" Rigid conduit in 95 seconds.
- Optional 1813 Bending Table and accessories for easier operation.

SPECIFICATIONS

Capacity	Weight
2-1/2" - 4" EMT, IMC and Rigid	881CT-E980: 999 lbs. (454 kg)
Power Source	881-E980: 930 lbs. (422 kg)
980: 120 VAC Electric Powered Hydraulic Pump	881: 856 lbs. (388 kg)
980-22PS: 220 VAC 50/60 Cycle Electric Powered Hydraulic Pump	881 BASIC: 358 lbs. (163 kg)
	27555: 137 lbs. (62 kg)
	27556: 130 lbs. (59 kg)
	27557: 134 lbs. (61 kg)
	31274: 183 lbs. (83 kg)

CAM TRACK® BENDER CENTERLINE BENDING RADII FOR EMT, IMC AND RIGID CONDUIT

SIZE	881		881 CT, 881 CTD, 881 BASIC	
	CENTERLINE RADIUS	CENTERLINE RADIUS	SHOE GROUP	DEGREE OF BEND
2-1/2"	13-1/2" (342.9 mm)	13-1/2" (342.9 mm)	27554	90
3"	16" (406.4 mm)	16" (406.4 mm)	27555	90
3-1/2"	18-5/8" (473.1 mm)	18-5/8" (473.1 mm)	31281	90
4"	21" (533.4 mm)	20-7/8" (530.2 mm)	31274	90
3-1/2"		18-5/8" (473.1 mm)#	27556	45
4"		21" (533.4 mm)#	27557	45
		# 881 Basic Only		

Cam Track® Benders and Shoe Groups

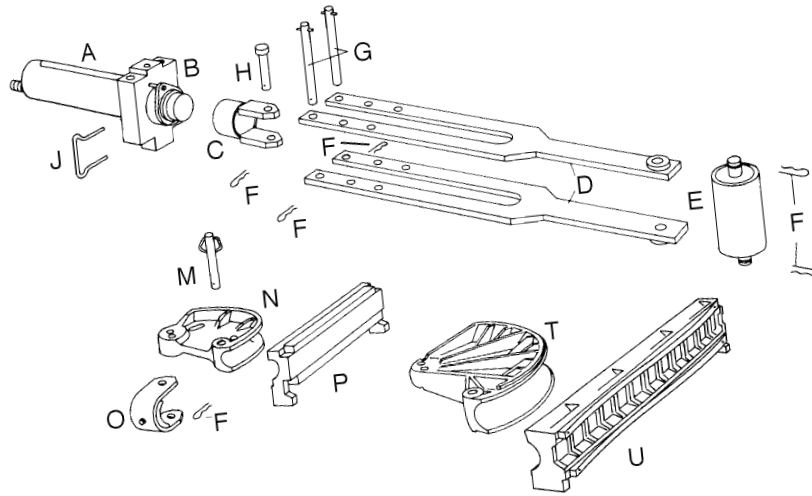

KEY	CAT. NO.	UPC NO.	DESCRIPTION	BENDERS				SHOE GROUPS							
				881	881A	881BASIC	881CT & 881CTD	27554	27555	31281	27556	31274	27557		
A	27416	27416	Hydraulic Ram with 4018GB female quick coupler. The ram includes Keys B, G, and two clips from Key F.	1	†	1	1								
B	27417	27417	Cylinder Block	1	1	1	1								
C	30309	30309	Yoke	1	1	1	1								
D	26309	26309	Connecting Bar Unit	2	2	2	2								
E	27364	27364	Roller Unit-The roller unit includes two clips from Key F	1	1	1	1								
F	50302	50302	Hitch Pin Clips	6	6	6	6								
G	27381	27381	Cylinder Block Pin Unit	2	2	2	2								
H	26306	26306	Yoke Pin	1	1	1	1								
J	26349	26349	Spring Clip (secures Yoke Unit to Ram)	1	1	1	1								
	11289	11289	3/8" x 6' (9.5 x 1829 mm) Hydraulic Hose with two 4033GB male quick couplers	1		1	1								
M	26624	26624	Saddle Pin Unit - includes 1 clip from Key F	1	1	1	1								
N	26297	26297	2-1/2" Shoe 90°	1	1		1	1							
P	26366	26366	2-1/2" Follow Bar 90°	1	1		1	1							
O	26580	26580	2-1/2" Saddle	1	1		1	1							
N	26300	26300	3" Shoe 90°	1	1		1		1						
P	35400	35400	3" Follow Bar 90°	1	1		1		1						
O	26584	26584	3" Saddle	1	1		1		1						
N	26302	26302	3-1/2" Shoe 45°	1	1							1			
P	26389	26389	3-1/2" Follow Bar 45°	1	1							1			
O	26588	26588	3-1/2" Saddle	1	1			1*			1	1			
T	31882	31882	3-1/2" Shoe 90°					1*			1				
U	31881	31881	3-1/2" Follow Bar 90°					1*			1				
N	26305	26305	4" Shoe 45°	1	1										1
P	31292	31292	4" Follow Bar 45°	1	1										1
O	26594	26594	4" Saddle	1	1			1					1	1	
T	31884	31884	4" Shoe 90°					1						1	
U	31883	31883	4" Follow Bar 90°					1						1	
	2460	23363	Steel Storage Box (not shown)	1	1	1	1								
	695	30239	Caster Set (not shown)	1		1	1								

† Use Hydraulic Ram from your 884 or 885 Bender. *Not included in 881 CTD.



Rigid Conduit Bender for 1/2", 3/4", 1", 1-1/4", 1-1/2" and 2"

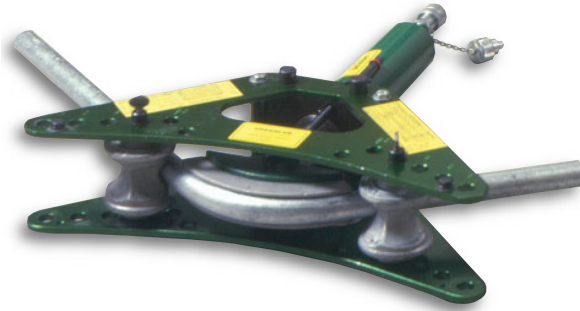

- Strong, portable pin-assembled aluminum components.
- Easy-to-use ram travel scale and bending charts.
- Conduit supports index to suit all sizes.
- Model available to bend PVC coated rigid conduit.

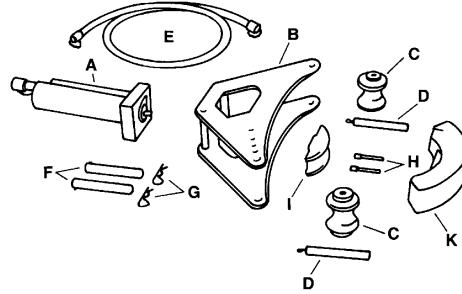

CAT. NO.	UPC NO.	DESCRIPTION
880	16480	1", 1-1/4", 1-1/2" and 2" Rigid Conduit Bender without hydraulic pump
880H755	16464	1", 1-1/4", 1-1/2" and 2" Rigid Conduit Bender with 755 Hand Hydraulic Pump
880E975	34200	1", 1-1/4", 1-1/2" and 2" Rigid Conduit Bender with 975 Electric Hydraulic Pump
1802	21257	Bending Table (Optional)
21357	21357	Conduit Support Pin for use with 1802 Bending Table – (2) Required
10917	10917	1/2" Shoe (Optional)
10918	10918	3/4" Shoe (Optional)

CENTERLINE BENDING RADII FOR 880 & 880 PVC BENDERS

Rigid Shoe Size	1/2"	3/4"	1"	1-1/4"	1-1/2"	2"
Bending Radius-Inches	4"	4-1/2"	5-3/4"	7-1/4"	8-1/4"	9-1/2"
Bending Radius-cm	10.16	11.43	14.60	18.41	20.95	24.13

SPECIFICATIONS

Capacity

880: 1" - 2" Rigid conduit

Power Source

755: Hydraulic Hand Pump 975: 120 VAC Electric Hydraulic Pump

980: 120 VAC Electric Hydraulic Pump

Weight

880: 113 lbs. (52 kg) 880E975: 172 lbs. (78 kg)

880H755: 135 lbs. (61 kg) 880PVC: 116 lbs. (53 kg)

See page 82 for optional shoes and accessories for PVC coated rigid conduit.

KEY	CAT. NO.	UPC NO.	DESCRIPTION	880	880PVC
A	747	16249	Hydraulic Ram with 4018GB female quick coupler, includes Keys F, G and one H	1	1
B	03396	03396	Frame Unit	1	1
C	03400	03400	Conduit Support	2	
D	13679	13679	Conduit Support Pin	2	2
E	11289	11289	3/8" x 6' (9.5 x 1829 mm) Hydraulic Hose with two 4033GB male quick couplers	1	1
F	15829	15829	Cylinder Head Pin Unit with Spring Clips 2725AA (Key G)	2	2
G	50302	50302	Spring Clips	2	2
H	10826	10826	Ram Pin, Shoe Pin	2	2
I	10939	10939	Shoe Support	1	1
K	10919	10919	1" Shoe – Rigid	1	
K	10920	10920	1-1/4" Shoe – Rigid	1	
K	10921	10921	1-1/2" Shoe – Rigid	1	
K	10922	10922	2" Shoe – Rigid	1	
	14909	14909	Steel Storage Box (not shown)	1	1

Rigid Conduit Bender for 1-1/4" - 2" one shot 90°s and 2-1/2" - 4" segment bending

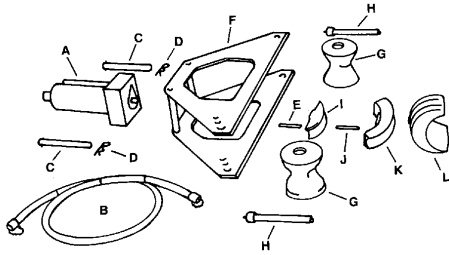
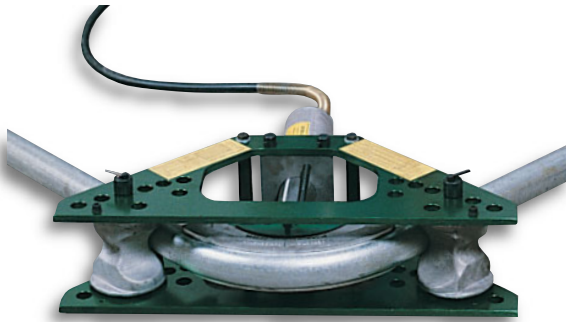

- Strong, portable pin-assembled aluminum components.
- Easy to use ram travel scale and bending charts.
- Conduit supports index to suit all sizes.

CAT. NO.	UPC NO.	DESCRIPTION
777	16491	1-1/4" through 2" One-Shot and 2-1/2" through 4" Segment, Rigid Conduit Bender without hydraulic pump
777HC755	16470	1-1/4" through 2" One-Shot and 2-1/2" through 4" Segment, Rigid Conduit Bender with 755 Hand Hydraulic Pump
777E975	34198	1-1/4" through 2" One-Shot and 2-1/2" through 4" Segment, Rigid Conduit Bender with 975 Electric Hydraulic Pump
1802	21257	Bending Table (Optional)
21359	21359	Conduit Support Pin for use with 1802 Bending Table – (2) Required

CENTERLINE BENDING RADII FOR 777 BENDERS

Rigid Shoe Size	SEGMENT BEND ONLY						
	1-1/4"	1-1/2"	2"	2-1/2"	3"	3-1/2"	4"
Bending Radius-Inches	7-1/4"	8-1/4"	9-1/2"	11-7/16"	13-3/4"	16"	18-1/4"
Bending Radius-mm	184.1	209.5	241.3	290.5	349.3	406.4	463.6

SPECIFICATIONS

Capacity	1-1/4" - 4" Rigid conduit
Power Source	755: Hydraulic Hand Pump 975: 120 VAC Electric Hydraulic Pump 980: 120 VAC Electric Hydraulic Pump
Weight	777: 164 lbs. (75 kg). 777HC755: 173 lbs. (79 kg) 777E975: 508 lbs. (231 kg)

KEY	CAT. NO.	UPC NO.	DESCRIPTION	777
A	1736	13251	Hydraulic Ram with 4018GB female quick coupler, includes Keys C thru E	1
B	11289	11289	3/8" x 6' (9.5 x 1829 mm) Hose with two 4033GB male quick couplers	1
C	13252	13252	Cylinder Head Pin Unit with Spring Clip 2725AA (Key D)	2
D	50302	50302	Spring Clip	2
E	10826	10826	Ram Pin	1
F	13232	13232	Frame Unit	1
G	13193	13193	Conduit Support	2
H	14496	14496	Conduit Support Pin	2
I	10939	10939	Small Shoe Support 1/2" thru 2"	1
J	10826	10826	Shoe Pin	1
K			90° Aluminum Bending Shoes	
	10920	10920	1-1/4" Shoe	1
	10921	10921	1-1/2" Shoe	1
	10922	10922	2" Shoe	1
L			Aluminum Segment Bending Shoes	
	13208	13208	2-1/2" Shoe	1
	13209	13209	3" Shoe	1
	13210	13210	3-1/2" Shoe	1
	13211	13211	4" Shoe	1
M	13382	13382	Steel Storage Box (not shown)	1

Shoes for heavier schedule pipe on page 82.

Rigid Conduit Benders for One-Shot 90°s in 1-1/4" - 4" (5" with Segment Bending Shoe)

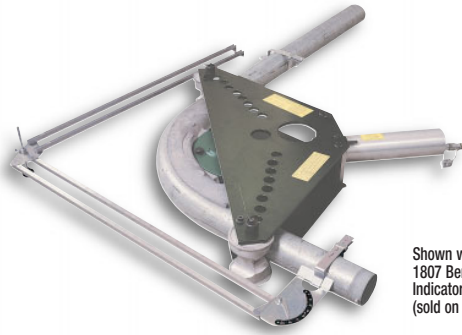

Shown with OPTIONAL 1807 Bending Degree Indicator (sold on page 84).

- Strong yet lightweight portable pin-assembled aluminum components.
- Easy to use ram travel scale and charts for accurate bends.
- Make elbows, offsets and saddles.
- Both 884 and 885 bend one-shot 90°s in 1-1/4" - 4" Rigid conduit. The 885 segment bends 5".
- Optional shoes available to bend PVC coated Rigid conduit.
- Optional 1802 Bending Table available for easier operation.

SPECIFICATIONS

Capacity

884: 1-1/4" - 4" Rigid conduit. 884PVC: 1-1/4" - 4" 40 mil PVC Coated Rigid conduit. 885: 1-1/4" - 5" Rigid conduit

Power Source

980: 120 VAC Electric Powered Hydraulic Pump
980-22PS: 220 VAC 50/60 Cycle Electric Powered Hydraulic Pump

Weight

884:	421 lbs. (191 kg)	885:	449 lbs. (204 kg)
884E980:	494 lbs. (225 kg)	885E980:	527 lbs. (239 kg)
884PVC:	388 lbs. (176 kg)		

CAT. NO.	UPC NO.	DESCRIPTION
884	16477	1-1/4" through 4" Rigid Conduit Bender, without hydraulic pump
884E980	34209	1-1/4" through 4" Rigid Conduit Bender, with 980 Electric Hydraulic Pump
884PVC	33614	1-1/4", 1-1/2", 2", 3" and 4" PVC Coated Rigid Conduit Bender without hydraulic pump
885	16751	1-1/4" through 4" One-Shot and 5" Segment Rigid Conduit Bender, without hydraulic pump
885E980	34210	1-1/4" through 4" One-Shot and 5" Segment Rigid Conduit Bender, with 980 Electric Hydraulic Pump
1802	21257	Bending Table (Optional)

Shoes for heavier schedule pipe and 40 mil PVC Coated Rigid Conduit on page 82.

Rigid Conduit Benders for One-Shot 90°s in 1-1/4" - 4" (5" with Segment Bending Shoe)

884 CENTERLINE BENDING RADII

SIZE	RIGID	SIZE	PVC RIGID	SIZE	RIGID
1-1/4"	7-1/4" (184.1 mm)	1-1/4"	7-1/4" (184.1 mm)	1-1/4"	7-1/4" (184.1 mm)
1-1/2"	8-1/4" (209.5 mm)	1-1/2"	8-1/4" (209.5 mm)	1-1/2"	8-1/4" (209.5 mm)
2"	9-1/2" (241.3 mm)	2"	9-1/2" (241.3 mm)	2"	9-1/2" (241.3 mm)
2-1/2"	12-1/2" (317.5 mm)	2-1/2"	11-7/16" (290.5 mm)	2-1/2"	12-1/2" (317.5 mm)
3"	15" (381 mm)	3"	13-3/4" (349.3 mm)	3"	15" (381 mm)
3-1/2"	17-1/2" (444.5 mm)	3-1/2"	16" (406.4 mm)	3-1/2"	17-1/2" (444.5 mm)
4"	20" (508 mm)	4"	18-1/4" (463.5 mm)	4"	20" (508 mm)
				5"	25" (635 mm)

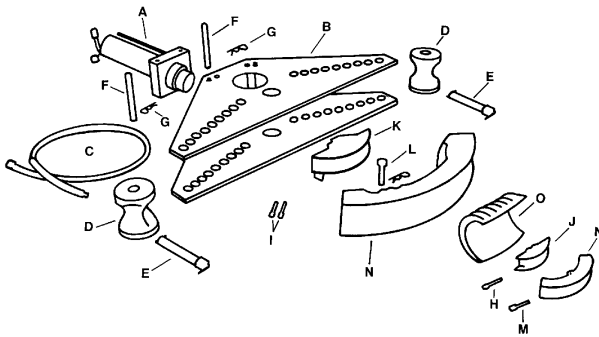

KEY	CAT. NO.	UPC NO.	DESCRIPTION	884	884PVC	885
A	1737	16752	Hydraulic Ram with 4018GB female quick coupler, includes Keys F thru I.	1	1	1
B	16754	16754	Frame unit	1	1	1
C	11289	11289	3/8" x 6' (9.5 x 1829 mm) Hydraulic Hose with two 4033GB male quick couplers	1	1	1
D	15671	15671	Conduit Support	2		2
	33454	33454	Conduit Support (not shown)			2
E	16747	16747	Conduit Support pin	2	2	2
F	16753	16753	Cylinder Head Pin Unit with Spring Clip 2725AA	2	2	2
G	50302	50302	Spring Clip	2	2	2
H	25184	25184	Ram Pin	1	1	1
I	10946	10946	Large Ram Pin	2	2	2
J	10939	10939	Small Shoe Support (1/2" through 2")	1	1	1
K	16741	16741	Large Shoe Support (2-1/2" through 4")	1	1	1
L	10963	10963	Large Shoe Pin	1	1	1
M	10826	10826	Small Shoe Pin	1	1	1
	19811	19811	Steel Storage Box (not shown)	1	1	1
N	10920	10920	1-1/4" Shoe - Rigid	1		1
N	10921	10921	1-1/2" Shoe - Rigid	1		1
N	10922	10922	2" Shoe - Rigid	1		1
N	10923	10923	2-1/2" Shoe - Rigid	1		1
N	10924	10924	3" Shoe - Rigid	1		1
N	10925	10925	3-1/2" Shoe - Rigid	1		1
N	14265	14265	4" Shoe - 20" centerline radius - Rigid	1		1
O	15669	15669	5" Shoe - Rigid			1
N	33459	33459	1-1/4" Shoe - PVC			1
N	33463	33463	1-1/2" Shoe - PVC			1
N	33462	33462	2" Shoe - PVC			1
N	34340	34340	3" Shoe - PVC			1
N	34344	34344	4" Shoe - PVC			1
	34329	34329	7/8" Wrench (not shown)			1

Tubing Bender and Shoe Groups

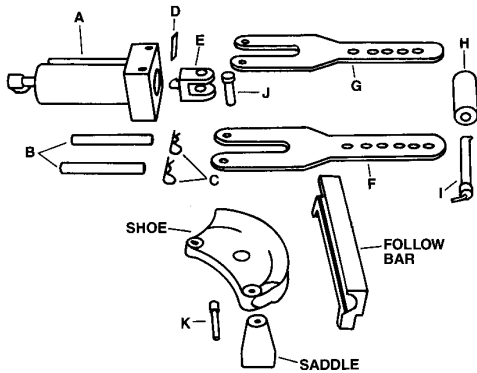
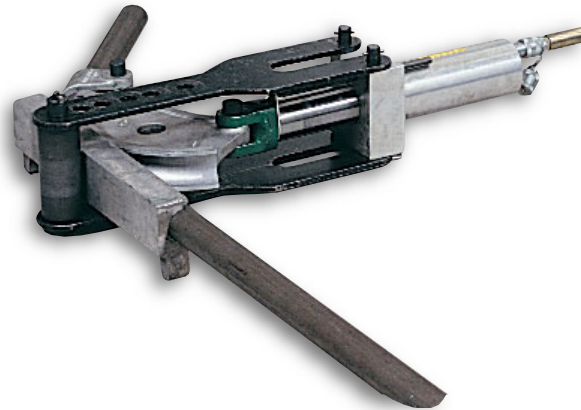

Purchase shoe groups individually to bend up to 90° bends in tubing with actual outside diameters of 3/4" to 2-1/8" tubing.

PARTS

KEY	CAT. NO.	UPC NO.	DESCRIPTION	QTY.
A	1736	13251	Hydraulic Ram with 4018GB female quick coupler, includes Keys B, C and J	1
B	13252	13252	Cylinder Pin Unit (includes Key C)	2
C	50302	50302	Spring Clip	2
D	10826	10826	Yoke Pin	1
E	06980	06980	Yoke	1
F	11083	11083	Lower Connecting Bar	1
G	06878	06878	Upper Connecting Bar	1
H	14094	14094	Roller	1
I	14496	14496	Roller Pin	1
J	04086	04086	Ram Pin	1
K	02937	02937	Saddle Pin for 1-1/2" and 2" Pipe Only	1
K	29937	29937	Saddle Pin for 1/2" through 1-1/4" Pipe and all tubing sizes	1
	11289	11289	3/8" x 6' (9.5 mm x 1829 mm) High-Pressure Hose with two 4033GB male quickcouplers (not shown)	1
	13382	13382	Steel Storage Box (not shown)	1

SHOE GROUPS FOR TUBING:

For brass, copper, steel and aluminum tubing with 1/16" (1.6 mm) minimum wall thickness. (Not for use with chrome moly tubing or pipe.) Also 3/4" through 1-1/2" O.D. bendable stainless steel tubing with wall thickness from .065" to .150". All shoes are aluminum.

CAT. NO.	UPC NO.	DESCRIPTION
782	24418	Tubing Bender without hydraulic pump or shoe groups.

SPECIFICATIONS

Capacity	Up to 2-1/8" (54 mm) diameter
Power Source	755: Hydraulic Hand Pump 975: 120 VAC Electric Hydraulic Pump 976-22PS: 220 VAC 50/60 Cycle Electric Hydraulic Pump
Weight	782: 124 lbs. (56.2 kg)

TUBING O.D. SIZE	SHOE RADIUS		SHOE GROUP		FOLLOW BAR SADDLE		
	INCH	mm	CAT. NO.	UPC NO.	SHOE CAT./ UPC NO.	BAR CAT./ UPC NO.	SADDLE CAT./ UPC NO.
3/4"	3-27/64"	86.9	TUG3	02550	11151	14280	16444
7/8"	3-27/64"	86.9	TUG4	02551	11150	11086	16445
1"	4-5/16"	109.5	TUG5	06842	11142	11117	16403
1-1/8"	4-5/16"	109.5	TUG6	02553	11144	11119	16413
1-1/4"	5-5/8"	142.9	TUG7	02554	11160	11124	16414
1-3/8"	5-5/8"	142.9	TUG8	02555	11159	11131	16415
1-1/2"	7-3/16"	182.6	TUG9	02556	11149	11129	16416
1-5/8"	7-3/16"	182.6	TUG10	02557	11148	11128	11080
1-3/4"	8-1/32"	204.0	TUG11	02558	20525	20526	16417
1-7/8"	8-1/32"	204.0	TUG12	02559	11156	11111	16443
2"	8-1/32"	204.0	TUG13	02560	11155	11109	11071
2-1/8"	9-17/64"	235.3	TUG14	02561	11133	11104	11070

Shoe groups to be used with Cat. No. 782 Tubing Bender only.



Accessories for Bending 40 Mil PVC Coated Rigid Conduit for 884 Benders



- Special size shoes and supports for bending 40 mil PVC Coated Rigid conduit.
- Two conduit supports to fit your bender are required. Shoe for 1-1/2" or larger have a cam device to force the conduit out of the shoe after bending. This requires a wrench to turn the cam.

BENDERS / PARTS

CAT. NO.	UPC NO.	DESCRIPTION
884PVC	33614	An 884 Bender with shoes, supports and wrench for bending 1-1/4", 1-1/2", 2", 3" and 4" 40 mil PVC Coated Rigid conduit. In a steel storage box. (See 884 Conduit Bender for details)

SHOE UNITS

40 MIL PVC COATED RIGID CONDUIT SIZE	CAT. NO.	UPC NO.	DESCRIPTION
1/2"	33456	33456	Shoe Unit 4" (101.6 mm) Centerline Radius
3/4"	33457	33457	Shoe Unit 4-1/2" (114.3 mm) Centerline Radius
1"	33458	33458	Shoe Unit 5-3/4" (146.1 mm) Centerline Radius
1-1/4"	33459	33459	Shoe Unit 7-1/4" (184.2 mm) Centerline Radius
1-1/2"	33463	33463	Shoe Unit 8-1/4" (209.6 mm) Centerline Radius
2"	33462	33462	Shoe Unit 9-1/2" (241.3 mm) Centerline Radius
2-1/2"	34321	34321	Shoe Unit 11-7/16" (290.5 mm) Centerline Radius
3"	34340	34340	Shoe Unit 13-3/4" (349.3 mm) Centerline Radius
3-1/2"	34342	34342	Shoe Unit 16" (406.4 mm) Centerline Radius
4"	34344	34344	Shoe Unit 18-1/4" (463.6 mm) Centerline Radius
—	33455	33455	880 Conduit Support – 2 Required
—	33454	33454	884 Conduit Support – 2 Required
—	34329	34329	7/8" Wrench. Use with 1-1/2" and larger shoes

Ductile Iron Bending Shoes for Bending Schedule 40 – Double X



- Use with 777, 880, 884 and 885 Benders.
- Bend up to 90° in one-shot.

CAPACITY

PIPE SCHEDULE	880	777	884	885
40 pipe	1-2"	1-2"	1-4"	1-4"
80 pipe	1-2"	1-2"	1-4"	1-4"
120 pipe	—	1-2"	1-4"	1-4"
160 pipe	—	1-2"	1-3"	1-3"
Double X	—	1-1-1/2"	1-3"	1-3"

SHOES

SIZE	CAT. NO.	UPC NO.	DESCRIPTION
1"	18764	18764	Ductile Iron Shoe 5-3/4" (146.1 mm) Centerline Radius
1-1/4"	18743	18743	Ductile Iron Shoe 7-1/4" (184.2 mm) Centerline Radius
1-1/2"	18745	18745	Ductile Iron Shoe 8-1/4" (209.6 mm) Centerline Radius
2"	18747	18747	Ductile Iron Shoe 9-1/2" (241.3 mm) Centerline Radius
2-1/2"	19504	19504	Ductile Iron Shoe 12-1/2" (317.5 mm) Centerline Radius
3"	19506	19506	Ductile Iron Shoe 15" (381.0 mm) Centerline Radius
4"	19508	19508	Ductile Iron Shoe 20" (508.0 mm) Centerline Radius

Bending Table (only) for 777, 880, 883, 884 and 885 Rigid Conduit Benders

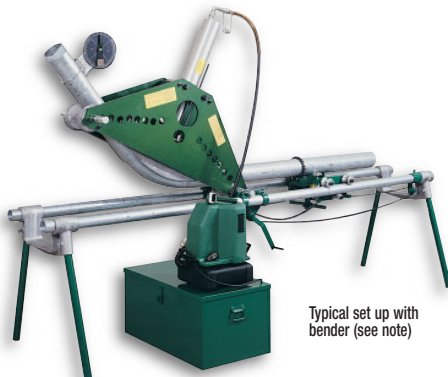

Typical set up with bender (see note)

- Make bending easier, faster and more accurate.
- Insert conduit to be bent in chain vise, tighten. Turn handle to move the chain vise and position conduit for bending.
- Use the Bending Degree Protractor and the movable chain vise to advance conduit while making segment and other multi-shot large sweep bends.
- Includes 1805 Bending Degree Protractor and metal storage box.

CAT. NO.	UPC NO.	DESCRIPTION
1802	21257	Bending Table - includes pipe support pins for 884 or 885 Benders.
21359	21359	Pipe Support Pin for use with 777, 883 and 883-4 Benders, two (2) are required (Optional)
21357	21357	Pipe Support Pin for use with 880 Bender, two (2) are required (Optional)

NOTE: To complete set up as shown two 10-foot (3.04 m) lengths of 2" Rigid conduit and Bender are required (purchased separately).

Bending Table (only) for 777, 880, 883, 884 and 885 Rigid Conduit Benders

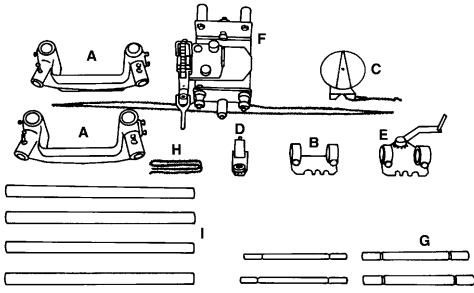

SPECIFICATIONS

Capacity	777, 880, 883, 884 and 885 Benders
Weight	180 lbs. (82 kg)

PARTS

KEY	CAT. NO.	UPC NO.	DESCRIPTION	1802/ 21257
A	21541	21541	Leg Support Unit	2
B	21545	21545	Bender Bracket Unit	1
C	1805	21318	Bending Degree Protractor	1
D	21542	21542	Chain Idler Unit	1
E	21543	21543	Crank Bracket Unit	1
F	21544	21544	Pipe Vise Unit	1
G	21360	21360	Pipe Support Pin – 1-1/2" for 884 and 885 Bender	2
H	21413	21413	Chain Extension Kit	1
I	21346	21346	Legs	4
	1531	23274	Steel Storage Box (not shown)	1

Bending Table (only) for 881 Benders

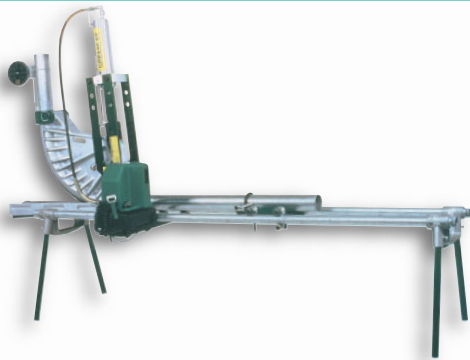

CAT. NO.	UPC NO.	DESCRIPTION
1813	28901	Bending Table for 881 Bender

NOTE: To complete set up as shown two 10-foot (3.04 m) lengths of 2" Rigid conduit and Bender are required (purchased separately).

SPECIFICATIONS

Capacity	881 Benders	Weight	186 lbs. (85 kg)
-----------------	-------------	---------------	------------------

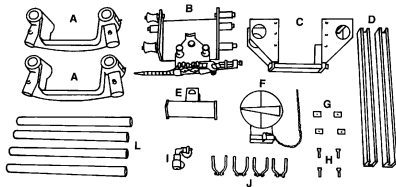

- Converts the 881 Bender into a comfortable, bench-high machine . . . reduces operator fatigue . . . makes loading faster, easier.
- Offset and one-shot bends in all four types of conduit are made quickly and easily with consistent accuracy.
- Pipe vise holds conduit securely for accurate bends. Prevents conduit from twisting or turning during bend.
- Includes 1805 Bending Degree Protractor and metal storage box.

PARTS

KEY	CAT. NO.	UPC NO.	DESCRIPTION	1813/ 28901
A	21541	21541	Leg Support Unit	2
B	28900	28900	Carriage Unit w/vise	1
C	28885	28885	Bender Mounting Unit	1
D	29004	29004	Pump Table Support	2
E	29022	29022	Ram Positioner	1
F	1805	21318	Bending Degree Protractor	1
G	53824	53824	Pump Bracket	4
H	51185	51185	Pump Mounting Screw	4
I	29014	29014	90° Coupling Unit	1
J	53014	53014	Steel Conduit Clamp	4
L	21346	21346	Legs	4
	1531	23274	Steel Storage Box (not shown)	1
	51593	51593	Hex Nut	4
	50975	50975	Cap Screw	4
	51674	51674	Washer	4

Bending Degree Protractor for use with 1802 and 1813 Bending Tables



- Bending Degree Protractor for use with 1802 and 1813 Bending Tables
- Use to make concentric offset or large-radius bends.
- Bender must be mounted on a bending table . . . and pipe bent in a vertical position.
- Quick-adjusting chain-type clamp for easy mounting to all conduit and pipe sizes.
- Face of protractor rotates to compensate for any surface that is not level.

CAT. NO.	UPC NO.	DESCRIPTION
1805	21318	Bending Degree Protractor

SPECIFICATIONS

Capacity	Protractor face is graduated in quadrants of 18, 20, 21 and 30 shots
Weight	2 lbs. (.91 kg)



Protractor with Magnetic Base



CAT. NO.	UPC NO.	DESCRIPTION
1895	35905	Angle Protractor with Magnetic Base

SPECIFICATIONS

Weight	0.4 lbs. (0.2 kg)
---------------	-------------------

Bending Degree Indicator

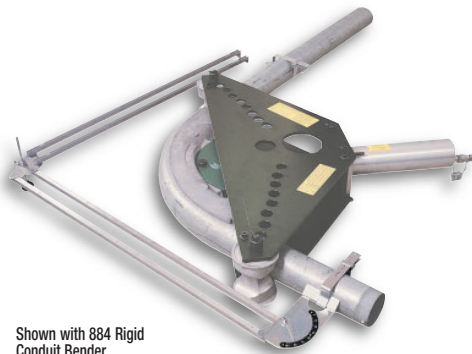

Shown with 884 Rigid Conduit Bender.

- Accurate way to measure degree of bend on 1/2" through 4" conduit.
- Can be used with all horizontal-type benders.
- Large easy-to-read 0° to 90° scale.
- Quick-adjusting clamps for easy mounting on 1/2" through 4" conduit.

CAT. NO.	UPC NO.	DESCRIPTION
1807	12743	Bending Degree Indicator

SPECIFICATIONS

Capacity	1/2" - 4" Conduit
Weight	15 lbs. (6.8 kg)

Bending Handbook and Slide Rule Bending Calculators



- 60 pages of bending information on stub ups, offsets, saddles and concentric bends.
- Pocket size 3-1/2" x 6-3/4".
- Bending charts for Greenlee Benders.
- Easy to use for fast, accurate bending calculations.

CAT. NO.	UPC NO.	DESCRIPTION
38405	38405	Bending Book
38406	38406	Slide Rule Calculator for 777, 880, 883, 884 and 885 Benders
38407	38407	Slide Rule Calculator for segment bends
38408	38408	Slide Rule Calculator for 881 and 882 Benders

Conduit Size Chart

SIZE	EMT ELECTRICAL METALLIC TUBING						IMC INTERMEDIATE CONDUIT						RIGID CONDUIT STEEL OR ALUMINUM					
	OUTSIDE DIA.		INSIDE DIA.		WALL THICKNESS		OUTSIDE DIA.		INSIDE DIA.		WALL THICKNESS		OUTSIDE DIA.		INSIDE DIA.		WALL THICKNESS	
	INCHES	mm	INCHES	mm	INCHES	mm	INCHES	mm	INCHES	mm	INCHES	mm	INCHES	mm	INCHES	mm	INCHES	mm
1/2"	.706	17.9	.622	15.8	.042	1.1	.815	20.7	.675	17.1	.070	1.8	.840	21.3	.622	15.8	.109	2.8
3/4"	.922	23.4	.824	20.9	.049	1.3	1.029	26.1	.879	22.3	.075	1.9	1.050	26.7	.824	20.9	.113	2.9
1"	1.163	29.5	1.049	26.6	.057	1.5	1.290	32.8	1.120	28.4	.085	2.2	1.315	33.4	1.049	26.6	.133	3.4
1-1/4"	1.510	38.4	1.380	35.1	.065	1.7	1.638	41.6	1.468	37.3	.085	2.2	1.660	42.2	1.380	35.0	.140	3.6
1-1/2"	1.740	44.2	1.610	40.9	.065	1.7	1.883	47.8	1.703	43.3	.090	2.3	1.900	48.3	1.610	40.9	.145	3.7
2"	2.197	55.8	2.067	52.5	.065	1.7	2.360	59.9	2.170	55.1	.095	2.4	2.375	60.3	2.067	52.5	.154	3.9
2-1/2"	2.875	73.0	2.731	69.4	.072	1.8	2.857	72.6	2.597	66.0	.130	3.3	2.875	73.0	2.469	62.7	.203	5.2
3"	3.500	88.9	3.356	85.2	.072	1.9	3.476	88.3	3.216	81.7	.130	3.3	3.500	88.9	3.068	77.9	.216	5.5
3-1/2"	4.000	101.6	3.834	97.4	.083	2.1	3.971	100.9	3.711	94.3	.130	3.3	4.000	101.6	3.548	90.1	.226	5.7
4"	4.500	114.3	4.334	110.1	.083	2.1	4.466	113.4	4.206	106.8	.130	3.3	4.500	114.3	4.026	102.3	.237	6.0
5"	—	—	—	—	—	—	—	—	—	—	—	—	5.563	141.3	5.047	128.2	.258	6.5
6"	—	—	—	—	—	—	—	—	—	—	—	—	6.625	168.3	6.065	154.0	.280	7.1

PVC Bending Selection Guide

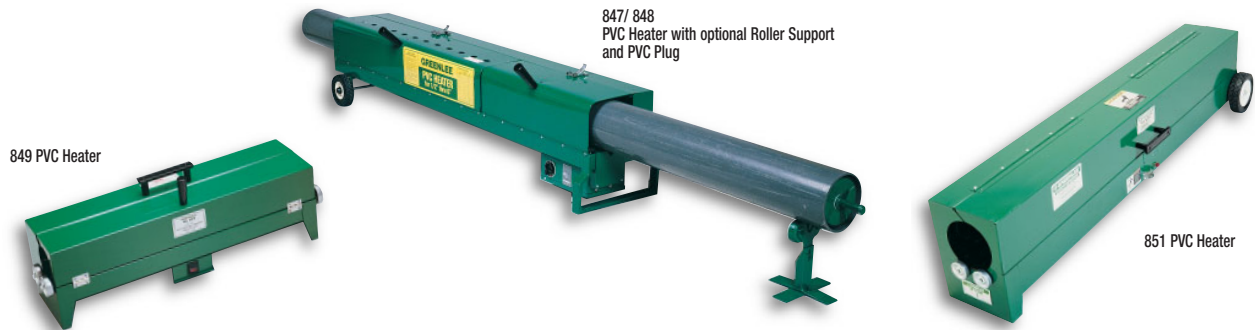

PVC HEATING

CAT. NO. – DESCRIPTION	PAGE NO.	1/2"	3/4"	1"	1-1/4"	1-1/2"	2"	2-1/2"	3"	3-1/2"	4"	5"	6"
860-1-1/2 PVC Heating Blanket	20	✓	✓	✓	✓	✓							
860-3 PVC Heating Blanket	20						✓	✓	✓				
860-4 PVC Heating Blanket	20									✓	✓		
849 PVC Heater	21	✓	✓	✓	✓	✓	✓						
851 PVC Heater	21	✓	✓	✓	✓	✓	✓	✓	✓	✓	✓		
847 / 848 PVC Heater	21	✓	✓	✓	✓	✓	✓	✓	✓	✓	✓	✓	✓

PVC Heating Blankets for up to 4", All schedules



- Make bends, offsets or saddles in PVC fast and easy.
- Easy to use: wrap blanket around PVC, secure with hook and loop strap. Built-in stiffeners help keep the blanket tight to the PVC surface. Remove blanket and form bend by hand.
- Controlled, even heating for uniform bending.
- Heavy-duty cord and thermostat for long life.
- Temperature over 300° F (149° C).

SPECIFICATIONS

	860-1-1/2	860-3	860-4
Capacity	Up to 1-1/2" PVC All Schedules	2" - 3" PVC All Schedules	3-1/2" - 4" PVC All Schedules
Power Source	120 VAC	120 VAC	120 VAC
Size	13" x 8-1/4" (330.2 x 209.6 mm)	30" x 13-1/4" (762.0 x 336.6 mm)	38" x 16-1/4" (965.2 x 412.8 mm)
Weight	1.7 lbs. (.8 kg)	3.3 lbs. (1.5 kg)	4.9 lbs. (2.2 kg)
Wattage	200	800	1300

CAT. NO.	UPC NO.	DESCRIPTION
860-1-1/2	31486	PVC Heating Blanket for up to 1-1/2"
860-3	31487	PVC Heating Blanket for 2" - 3"
860-4	31488	PVC Heating Blanket for 3-1/2" and 4"

Electric PVC Heater/Bender for 1/2" - 2", All schedules

 120 VAC
 20 AMP

- Easy to use: preheat for 10 minutes, insert PVC, rotate until pliable, remove and form bend.
- Sturdy double wall metal with fiberglass insulation and reflective interior for fast, even heat.
- Full length door for easy PVC loading and removal.
- Other features include on/off switch, pilot light and carrying handle.

CAT. NO.	UPC NO.	DESCRIPTION
849	27395	Electric PVC Heater for 1/2"- 2"
27811	27811	Calrod Heating Element

SPECIFICATIONS

Capacity	1/2" - 2" PVC All Schedules
Power Source	120 VAC 20 AMP or 3000 Watt Generator
Weight	15 lbs. (6.8 kg)

Electric PVC Heater/Bender for 1/2" - 4", All schedules

 120 VAC
 20 AMP

- Easy to use: preheat for 10 minutes, open lid and position PVC, close lid, rotate until pliable, open lid, remove PVC and form bend.
- Heavy-duty, insulated metal walls and cover with reflective interior for efficient, even heat.
- Full length door for easy loading and unloading.
- On/off switch with indicator light.
- Sturdy wheels for easy mobility.
- Use two units in tandem to heat large sweep bends.

CAT. NO.	UPC NO.	DESCRIPTION
851	35577	Electric PVC Heater / Bender for 1/2" - 4"
35592	35592	Calrod Heating Element

See below for 2" - 4" PVC plugs or 859-4 PVC Plug Set.

SPECIFICATIONS

Capacity	1/2" - 4" PVC All Schedules
Power Source	120 VAC 20 AMP or 3600 Watt Generator
Length	52" (1321 mm)
Weight	53 lbs. (24 kg)
Wattage	2300

Electric PVC Heater/Bender for 1/2" - 6", All schedules

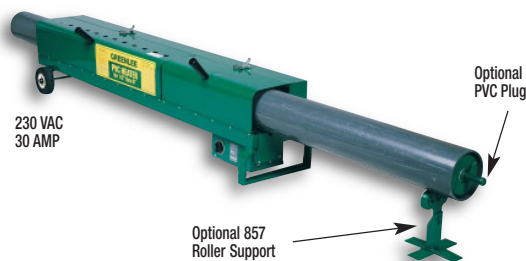
 230 VAC
 30 AMP

 Optional 857
 Roller Support

 Optional
 PVC Plug

- Easy to use: preheat for 10 minutes, open lid and position PVC, close lid, rotate until pliable, open lid, remove PVC and form bend. 848 model has motorized rotation.
- Heavy duty metal construction with reflective interior for fast, efficient heating.
- Has heating chart, timer, and on/off switch with indicator light for added convenience.
- Double doors with piano hinges allow heating shorter lengths with one door open.
- Sturdy wheels for easy mobility.

CAT. NO.	UPC NO.	DESCRIPTION
847	30866	Electric PVC Heater / Bender for 1/2" - 6"
848	30867	Electric PVC Heater / Bender with Motorized PVC Rotation for 1/2" - 6" All Schedules
31092	31092	Motorized PVC rotation kit for 847
857	31093	PVC Roller Support (optional)
30908	30908	Calrod Heating Element

SPECIFICATIONS

Capacity	1/2" - 6" PVC All Schedules
Power Source	230 VAC 30 AMP or 7000 Watt Generator
Length	71" (1803 mm)
Weight	847 - 78 lbs. (36 kg) 848 - 80 lbs. (37 kg)
Wattage	6600

PVC Plugs and Plug Set



- Use with PVC Heating Blankets or Electric Heaters to plug the ends of the PVC being heated. The trapped air will help keep the PVC from collapsing while forming the bend.
- Use on Schedule 40 and 80 PVC.
- Available in 2" - 4" set or individual sizes 2" - 6". Order two, one for each end of the PVC.

SPECIFICATIONS

Capacity	2" - 6" PVC Schedules 40 and 80	
Weight	859-4 - 8 lbs. (3.6 kg)	30979 - .6 lbs. (3.6 kg)
	30976 - .3 LBS. (.2 KG)	30980 - 1 LB. (.5 KG)
	30977 - .4 lbs. (.2 kg)	30981 - 1.3 lbs. (.6 kg)
	30978 - .4 lbs. (.2 kg)	

CAT. NO.	UPC NO.	DESCRIPTION
859-4	35740	PVC Plug Set for 2" - 4". Includes 2 each of 2", 2-1/2", 3" and 4" plugs and carrying case. Case has a place for optional 5" and 6" sizes
30976	30976	2" PVC Plug
30977	30977	2-1/2" PVC Plug
30978	30978	3" and 3-1/2" PVC Plug
30979	30979	4" PVC Plug
30980	30980	5" PVC Plug
30981	30981	6" PVC Plug
31228	31228	Plastic Carrying Case

PVC Cutter for up to 1"



- Cuts a wide range of PVC conduit, plastic pipe and rubber hose
- Lightweight, easy to put in tool pouch.
- Tough nylon handles.
- Replaceable stainless steel blade.

CAT. NO.	UPC NO.	DESCRIPTION
861	09861	PVC Cutter for up to 1"
07995	07995	Replacement Blade

SPECIFICATIONS

Capacity	Up thru 1" PVC
Weight	.24 lbs. (.1 kg)

PVC Cutter for up to 1-1/4"



- Ratchet action for fast, easy cutting.
- Heat-treated, replaceable steel blade for long cutting life.
- Rugged metal alloy frame for durability.

CAT. NO.	UPC NO.	DESCRIPTION
864	04253	PVC Cutter for up to 1-1/4"
00355	00355	Replacement Blade Kit

SPECIFICATIONS

Capacity	Up thru 1-1/4" PVC
Weight	.8 lbs. (.4 kg)

PVC Cutter for up to 2"



- High leverage compound ratchet action and long handles reduce effort.
- Heavy-duty metal frame for cutting large diameters.
- Sharpenable and replaceable tool steel blade.

CAT. NO.	UPC NO.	DESCRIPTION
865	09865	PVC Cutter for up to 2"
07978	07978	Replacement Blade

SPECIFICATIONS

Capacity	Up thru 2" PVC
Weight	2.5 lbs. (1.1 kg)

Chain-Type Pipe Vice



- Use with a wide range of sizes of pipe or conduit.
- Built-in pipe rest.
- To prevent marring of plastic or plastic coated pipe, vise jaws can be rotated with smooth side up. Use serrated side for harder materials.
- Chain design holds pipe securely to prevent it from twisting or turning during threading.

CAT. NO.	UPC NO.	DESCRIPTION
467	27318	Vise

SPECIFICATIONS

Capacity	1/8" - 5" (3.2 mm x 127 mm) pipe
Weight	17 lbs. (7.7 kg)

Thread Cutting Oil



- Premium quality, high lubricity for easier cutting and long tool life.
- Choice of light or dark.

CAT. NO.	UPC NO.	DESCRIPTION
462 Q	28237	Dark Threading Cutting Oil - 1 Qt.
462 1	26096	Dark Threading Cutting Oil - 1 Gal.
462 5	26100	Dark Threading Cutting Oil - 5 Gal.
463 Q	28238	Light Threading Cutting Oil - 1 Qt.
463 1	28239	Light Threading Cutting Oil - 1 Gal.

SPECIFICATIONS

CAT. NO.	SIZE	WEIGHT
462 Q, 463 Q	1 Qt. (.9 l)	2.3 lbs. (1 kg)
462 1, 463 1	1 Gal. (3.8 l)	8.7 lbs. (4 kg)
462 5	5 Gal. (18.9 l)	40 lbs. (18 kg)